

Fig. 25

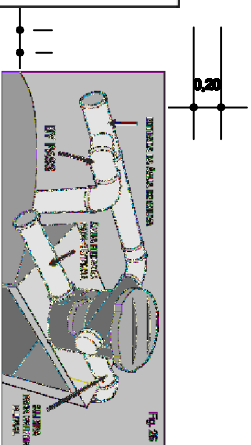
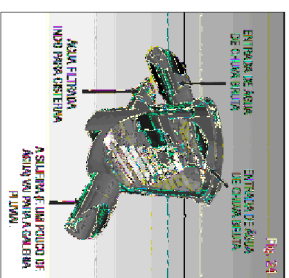

Fig. 26

Esquema By Pass

Esquema Montagem Sistema

8/ Escala



Detalhe Filtro

PRODUCED BY AN AUTODESK EDUCATIONAL PRODUCT

Acessórios Incluídos

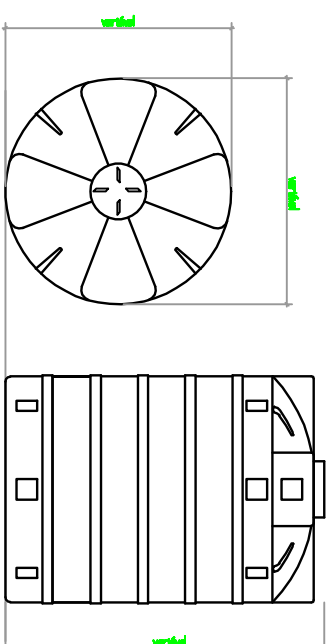
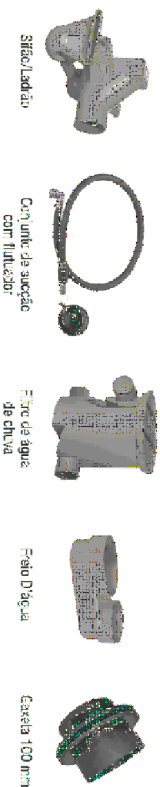

Sistema Equipado para Água de Chuva Acumulimp AM

DETALHE CONDUTOR

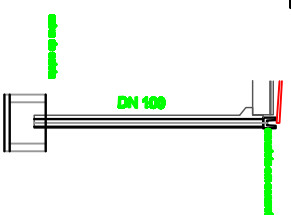

DETALHE INSTALAÇÃO DO CONDUTOR

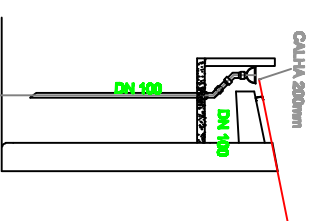

DETALHE CANALETA DRENAGEM DO TALUDE

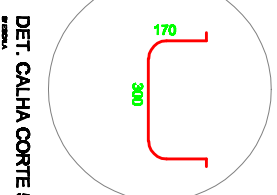
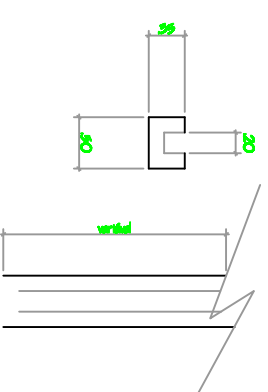

DET. CALHA CORTE 50

PRODUCED BY AN AUTODESK EDUCATIONAL PRODUCT

Para Instalação do Sistema, consultar o Manual/ Guia de Instalação Sistema Equipada para Água de Chuva Acumulimp 10.000 L.

SECRETARIA DE PLANEJAMENTO E OBRAS - DEP. DE OBRAS PÚBLICAS	
USP Projeto	Matheus
Projeto Executivo Água Pluvial - Novo	Proj. Arquit. Udo Peter Persechini
14/02/2011	0 4